

Interior-Timber Frame-Double Stud-CSR 2385  
FRL -/120/120  
120/120/120  
(From both sides)

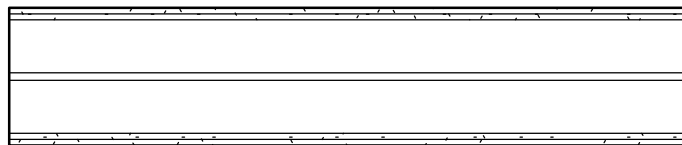
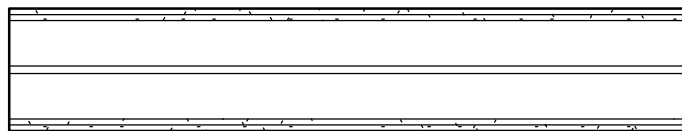
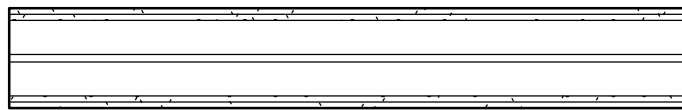
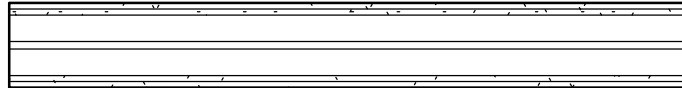

## Wall Schedule

| Wall Name                                       | Manufacturer | Fire Rating                                   | Acoustic Rating                                      |
|---|--------------|---|--|
| Interior-Timber Frame-Double Stud-CSR2385-224mm | CSR GYPROCK  | -/120/120 OR<br>120/120/120 (From both sides) | ACOUSTIC OPT (A 49/43) (B 60/52) (C 63/53) (D 55/49) |
| Interior-Timber Frame-Double Stud-CSR2385-264mm | CSR GYPROCK  | -/120/120 OR<br>120/120/120 (From both sides) | ACOUSTIC OPT (A 50/44) (B 61/53) (C 64/54) (D 56/50) |
| Interior-Timber Frame-Double Stud-CSR2385-324mm | CSR GYPROCK  | -/120/120 OR<br>120/120/120 (From both sides) | ACOUSTIC OPT (A 51/45) (B 62/54) (C 65/55) (D 57/51) |
| Interior-Timber Frame-Double Stud-CSR2385-364mm | CSR GYPROCK  | -/120/120 OR<br>120/120/120 (From both sides) | ACOUSTIC OPT (A 52/46) (B 63/55) (C 66/56) (D 58/52) |

### CSR BUILDING PRODUCTS LTD

Head Office: Triniti 3, 39 DELHI RD, NORTH RYDE NSW 2113  
LOCKED BAG 1345, NORTH RYDE BC NSW 1670  
A.B.N. 55 008 631 356 Ph: 1300 306 556 www.gyprock.com.au

TITLE Interior-Timber Frame-Double Stud-CSR2385

SCALE

1:20 @ A4

SHEET SIZE

A4

DRAWN

DL

DATE

13.10.16

SHEET NO.

1 of 1

CHECK

DL

REVISION

A

CSR